

MULTI-USE STAND

Copyright 2016 Héctor Acevedo and André Wagner

Base Side View

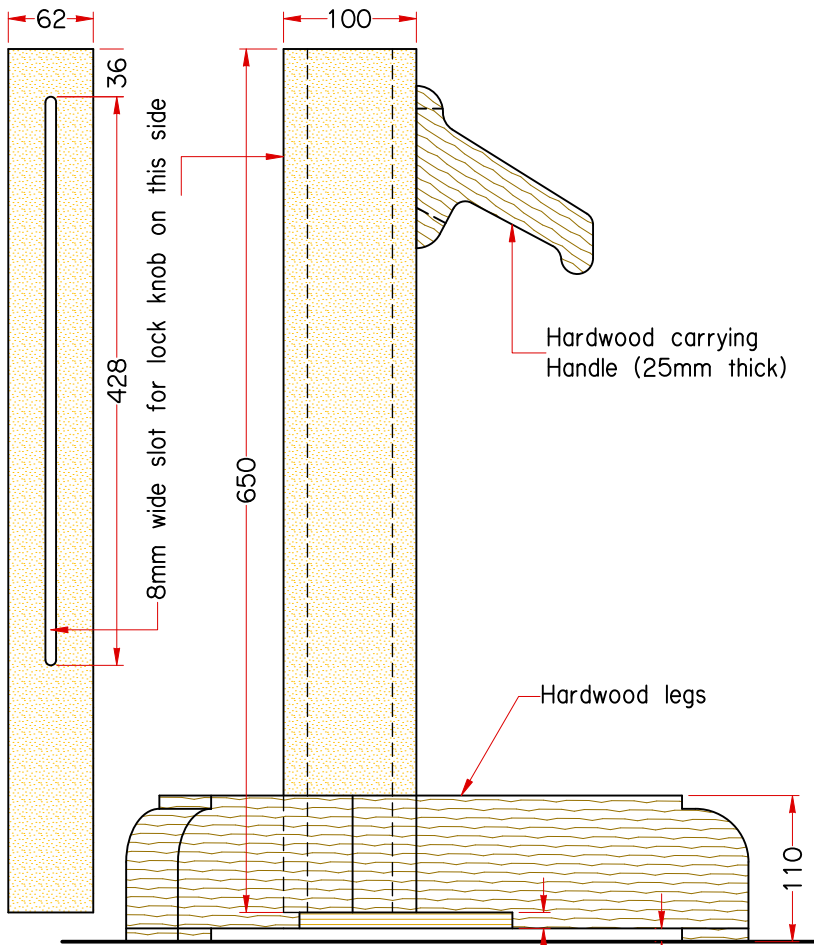

Top Plate Top View

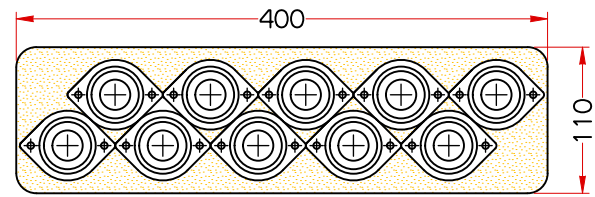

Top Plate Side View

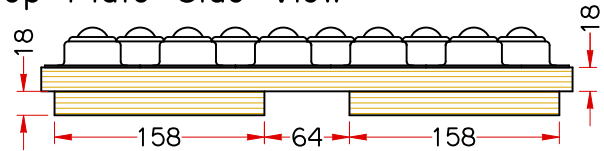

Top Plate Bottom View

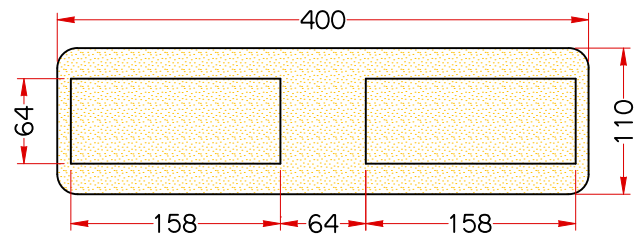

Stem Top View

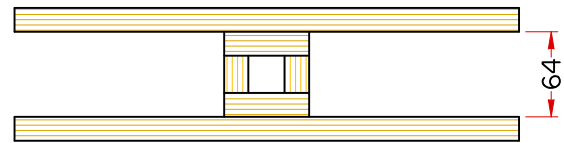

Stem Side View

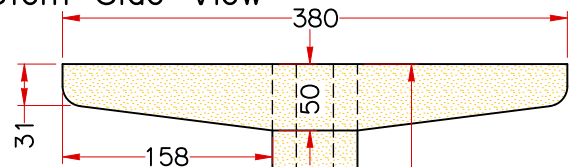

Central Plug

(27mm square hardwood with metal plate top)

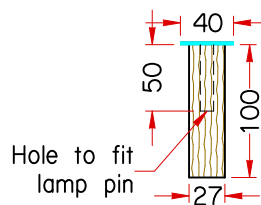

Base Top View

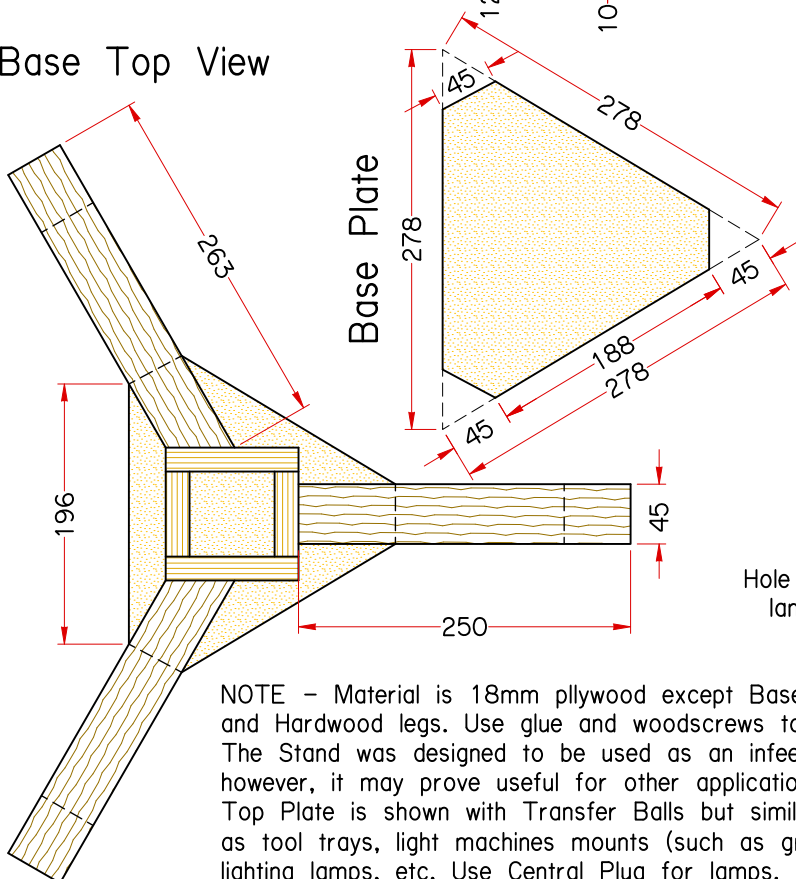

NOTE - Material is 18mm plywood except Base plate (12mm ply) and Hardwood legs. Use glue and woodscrews to assemble.

The Stand was designed to be used as an infeed/outfeed helper, however, it may prove useful for other applications.

Top Plate is shown with Transfer Balls but similar Plates can be built as tool trays, light machines mounts (such as grinders or scroll saws), lighting lamps, etc. Use Central Plug for lamps.

You may want to drill holes for a 6mm pin in the Stem corresponding to the height of different machines in your shop. This will enable to quickly set the desired height in the future.

